



PLANNING COMMITTEE

15 FEBRUARY 2012

APPENDICES

<u>APPENDIX</u>	<u>REPORT</u>	<u>PAGE NO</u>
A	MINUTES – 25.1.12	TO FOLLOW
B	WATERS EDGE, HAMM COURT, WEYBRIDGE, SURREY – SITE PLAN	1
C	PLANNING APPLICATIONS DETERMINED BY THE DIRECTOR OF TECHNICAL SERVICES	1a – 7
D	PLANNING APPLICATION : LAND AT PALMER CRESCENT, OTTERSHAW – INDICATIVE LAYOUT	8

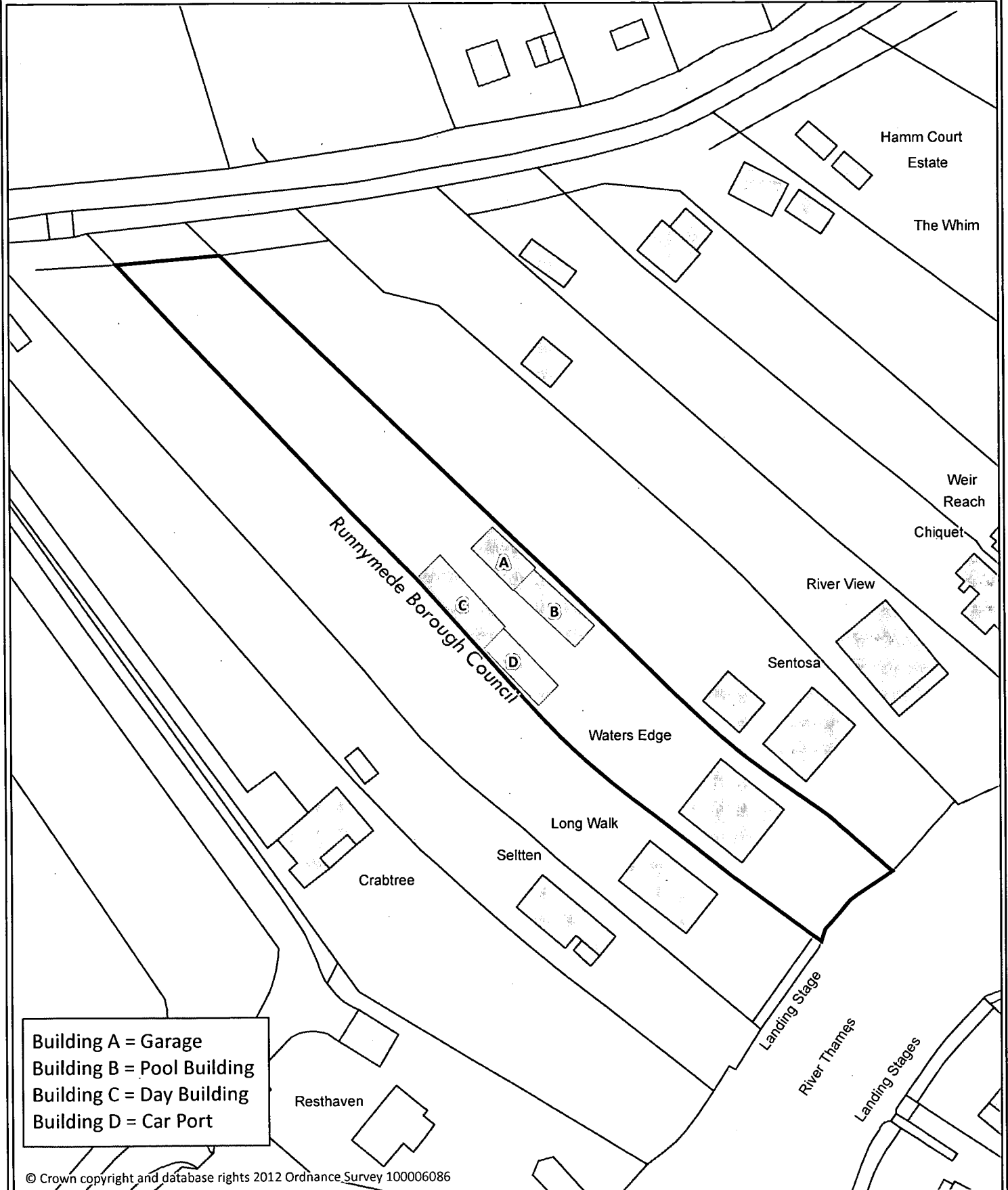
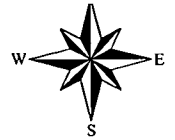

Building A = Garage
 Building B = Pool Building
 Building C = Day Building
 Building D = Car Port

© Crown copyright and database rights 2012 Ordnance Survey 100006086

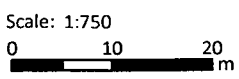

11E00018



PLANNING APPLICATIONS DETERMINED BY

DIRECTOR OF TECHNICAL SERVICES

9 JANUARY 2012 TO 27 JANUARY 2012

<u>APP. NO.</u>	<u>LOCATION AND PROPOSAL FOLLOWED BY DECISION</u>
11/0893	1 Lyne Grove Cottages, Lyne Lane, Lyne Erection of a detached outbuilding for the use of storage of hay and machinery to be used in the maintenance of land, woodland and riverbank (revised plans received correcting eaves and ridge height). DECISION: REFUSE
11/0952	Roundway, Sheerwater Avenue, Woodham Removal of condition 4 of planning permission RU.10/1047 to allow clear glazing and side hung casement window in bedrooms 1 and 3 on first floor north east side elevation, fully openable, clear glazed windows on first floor south west side elevation, and variation of condition 3 of planning permission RU.10/1047 to allow insertion of additional window on first floor south west side elevation (revised description 09.01.2012). DECISION: GRANT
11/1037	Richmond House, Oak End Way, Woodham Erection of part two storey, part single storey side and rear extensions and single storey front extension incorporating rooflights to single storey elements following demolition of existing single storey extension. DECISION: GRANT
11/1067	Dorchester House, Portnall Rise, Virginia Water Single storey extension to existing swimming pool building. DECISION: REFUSE
11/1068	20 Station Road, Chertsey Change of use of ground floor from a retail shop to a self contained 2 x bedroom flat. DECISION: GRANT
11/1101	29 Highfield Road, Chertsey Erection of a single storey side/rear extension incorporating insertion of rooflights following demolition of existing single storey rear element and construction of dormers to front and rear elevations to allow habitable accommodation in the roof area. DECISION: REFUSE
11/1107	Rathgar House, 188 High Street, Egham Proposed display of 2 no. x non-illuminate corporate logo fascia signs of front elevation. DECISION: GRANT

<u>APP. NO.</u>	<u>LOCATION AND PROPOSAL FOLLOWED BY DECISION</u>
11/1109	Somersby, Portnall Drive, Virginia Water Erection of two storey detached dwelling following demolition of existing dwelling with the retention of the existing detached garage/gym and provision of swimming pool and proposed entrance gates and pillars. DECISION: GRANT
11/1111	13A Rowtown, Addlestone Proposed lawful development certificate to establish whether planning permission is required for conversion of garage to habitable accommodation. DECISION: GRANT
11/1114	Crown Lodge, Englefield Green Conservation area consent for demolition of existing dwelling and detached garage. DECISION: GRANT
11/1117	227 Chertsey Road, Addlestone Erection of a single storey side extension incorporating a rooflight to rear. DECISION: REFUSE
11/1118	Flat 3, Northdene Court, 32 Egham Hill, Egham Erection of single storey side extension DECISION: GRANT
11/1119	Ruxbury Farm, St. Ann's Hill Road, Chertsey Consultation from Surrey County Council for retrospective planning application for the change of use of land at Ruxbury Farm from agriculture to a wood storage and wood chipping facility. DECISION: OBJECT
11/1121	17 Ferndale Avenue, Chertsey Erection of single storey rear, front and side extensions. Alterations and increase in height of existing roof and construction of dormer windows to both sides and front and insertion of rooflights to allow habitable accommodation at first floor (revised plans received). DECISION: GRANT
11/1124	19 Simons Walk, Englefield Green, Egham Erection of a single storey rear extension, new roof over existing single storey extension and new canopy roof to front elevation and two first floor side windows (southern elevation) and one new first floor window to northern elevation (amended description and plans). DECISION: GRANT
11/1126	22 Silver Birch Close, Woodham To fell Oak Tree, marked T2 on plan, in rear garden of 22 Silver Birch Close, Woodham and covered by TPO no. 366. DECISION: GRANT

<u>APP. NO.</u>	<u>LOCATION AND PROPOSAL FOLLOWED BY DECISION</u>
11/1128	1 Abbey River Cottage, Abbey Chase, Bridge Road, Chertsey Erection of single storey front and rear extensions following demolition of existing rear conservatory. DECISION: REFUSE
11/1129	Pinehurst, Heatherside Drive, Virginia Water Amendment to planning approval RU.11/0299 (erection of replacement dwelling) to include an increase in the eaves height over garage and main roof, alterations to roof configuration and fenestration, increase in footprint of building (by 17 sq.m.) and alterations to parking layout. DECISION: GRANT
11/1131	JB Waterski, Thorpe Lakes, Thorpe Road, Chertsey Erection of 12.5 sq.m. timber shelter DECISION: GRANT
11/1137	Corner Cottage, Guildford Road, Chertsey Crown reduction of a maximum of 20% and deadwood on Oak Tree marked T1, felling of one Fir Tree marked T2 and works to Holly Tree marked T3 on submitted plan and in garden of Corner Cottage, Guildford Road and covered by TPO no. 19. DECISION: GRANT
11/1138	Hayworth House & Geesemere, The Ashford & St. Peters Hospitals NHS Trust, Guildford Road, Chertsey Various works to trees protected under Tree Preservation Order 244. DECISION: GRANT
11/1141	121 Rowtown, Addlestone Proposed lawful development Certificate to establish whether planning permission is required for the installation of one dormer window in the northern and southern roof space. DECISION: GRANT
11/1142	4 Western Avenue, Thorpe Erection of a single storey side/rear extension, conversion of existing garage to habitable accommodation and construction of a new hipped roof over existing side element and new proposed extension. DECISION: GRANT
11/1146	Hope Spring, Ongar Road, Addlestone Erection of first floor rear extension incorporating a rooflight to side elevation. DECISION: GRANT
11/1147	Royal Holloway University of London, Egham Hill, Egham Variation of condition 2 of Listed Building Consent RU.10/1040 (for the temporary removal to provide for the restoration/repair and the refixing of four iron finials located on the four external corners of the building and two weathervanes over the east and west central entrances and the repair in-situ of two finials) to allow an extension of time for repair and re-fixing. DECISION: GRANT

APP. NO. LOCATION AND PROPOSAL FOLLOWED BY DECISION

- 11/1148 Tobbley Range, Clockhouse Lane West, Egham
Erection of a two bedroom, single storey timber agricultural workers cabin and siting of timber poultry shed.
DECISION: REFUSE
- 11/1150 14 Firfield Road, Addlestone
Erection of part two storey, part single storey rear extension
DECISION: GRANT
- 11/1151 46 Lindsay Road, New Haw
Erection of replacement front porch.
DECISION: GRANT
- 11/1152 20 Parsonage Road, Englefield Green, Egham
Erection of extension to garage with pitched roof over entire single storey side element following removal of shed, new bay window to front elevation to match opposite bay window with pitched roof extending over both windows and entrance door, new pitched roof to part of main dwelling in replacement of existing flat roof at first floor level and alterations to fenestration.
DECISION: GRANT
- 11/1153 11 Northcroft Road, Englefield Green, Egham
Erection of two storey front and single storey side extensions incorporating a raised roof lantern following demolition of existing garage.
DECISION: GRANT
- 11/1158 Top Golf, Moated Farm Drive, New Haw Road, Addlestone
Advertisement consent for 2 no. externally illuminated post mounted signs 2.4m x 1.85m
DECISION: REFUSE
- 11/1162 Surrey Towers, Garfield Road, Addlestone
The removal of 2 no. redundant 02 antennas and the installation of 3 no. Vodafone antennas and one 02 antenna on the existing tower on roof, the installation of Vodafone equipment within the existing 02 equipment room at ground level and works ancillary thereto.
DECISION: GRANT
- 11/1165 Land adj. Weybridge Rowing Club, Wey Navigation Canal, Weybridge
Crown lift one Lime Tree to 3.5m above ground level marked T1 on submitted plan, crown thin and crown lift group of Sycamores to 3.5m above ground level marked GRP1 on submitted plan and fell two Sycamores marked T2 and T3 on submitted plan protected by Conservation Area Status.
DECISION: GRANT
- 11/1168 Bombardiers Cottage, Fort Belvedere, London Road, Sunninghill
Listed building consent for installation of underfloor heating between joists on the ground and first floors.
DECISION: GRANT

<u>APP. NO.</u>	<u>LOCATION AND PROPOSAL FOLLOWED BY DECISION</u>
11/1169	<p>Little Mole, Coach Road, Ottershaw, Chertsey Certificate of existing lawfulness to establish whether the building known as Little Mole has been used as a separate dwellinghouse. DECISION: REFUSE</p>
11/1171	<p>30 Chaworth Road, Otterhsaw Erection of a single storey side extension DECISION: GRANT</p>
11/1175	<p>Kingswood, Meadow Road, Virginia Water Amendment to planning approval RU.11/0805 (Erection of replacement dwelling) to include replacement of existing greenhouses, garden store and workshop with 1 outbuilding incorporating changing room, store and summer house. DECISION: GRANT</p>
11/1178	<p>Round Oak, Bishopsgate Road, Englefield Green Alterations including removal of internal walls for the formation of a pair of first floor bedrooms and en-suite facilities. DECISION: GRANT</p>
11/1182	<p>Bombardiers Cottage, Fort Belvedere, London Road, Sunninghill Internal alterations including the removal of floor boards and joists from the ground floor and the insertion of a lowered insulated concrete deck with under floor heating installed over, new under floor heating installed between existing or new joists to first floor. DECISION: GRANT</p>
11/1185	<p>15A Limes Road, Egham To reduce height and width of Silver Birch in front garden of 15A Limes Road and protected by TPO No. 355. DECISION: GRANT</p>
11/1186	<p>Treehaven, Thorpe Lea Road, Egham Reduce by a maximum of 3 metres the branches closest to Tree Haven, Thorpe Lea Road, of Cedar Tree protected by TPO no. 12. DECISION: GRANT</p>
11/1187	<p>Rivers Lea, Hamm Court, Weybridge Application for an extension of the time limit for implementation of planning permission RU.09/0028 for the demolition of existing dwelling and garage and erection of replacement two storey dwelling and detached double garage. DECISION: GRANT</p>
11/1188	<p>1 Ayebridges Avenue, Egham Erection of an attached garage to side and rear of property incorporating gable end windows to front and rear elevations and rooflights to side elevation following demolition of existing garage. DECISION: REFUSE</p>

APP. NO. LOCATION AND PROPOSAL FOLLOWED BY DECISION

- 11/1189 Land adj. Holt House, 4 Chobham Road, Ottershaw
Variation of condition 2 (insertion of windows) of planning permission RU.09/0645 (demolition of existing double garage and erection of new single storey attached dwelling with access from Chobham Road and parking and ancillary works) to insert two roof lights in the rear lounge and dining room.
DECISION: GRANT
- 11/1193 Abbey Chase Farm, Abbey Chase, Bridge Road, Chertsey
Erection of storage building following removal of mess room and storage containers (alternative proposal to planning permission RU.10/0973)
DECISION: GRANT
- 11/1202 2 Simmons Place, Staines
Felling of one Lime Tree in rear garden of No.2 Simmons Place, tree covered by Tree Preservation Order No. 250.
DECISION: REFUSE
- 11/1206 431 Stroude Road, Virginia Water
Erection of a front infill extension and extension to front and rear of existing garage (revised plans received)
DECISION: GRANT
- 11/1213 Clarence House, Stuart Way, Virginia Water
Certificate of proposed lawful development to establish whether planning permission is required for part single storey and part two storey rear extension, single storey front extensions and single storey side extensions, new rear dormer, and for the erection of a plant room (outbuilding).
DECISION: GRANT
- 11/1226 Land adj. Wey Navigation, Addlestone Road, Addlestone
Repollarding a group of 17 Willow Trees marked GRP 1 on submitted plan to prevent collapse and loss of main trunks. Removal of a collapsed Willow Tree marked T1 on submitted plan as it has fallen onto a bridge. The trees are protected by Conservation Area status.
DECISION: GRANT
- 12/0011 Mercedes Benz World, Brooklands Drive, Weybridge
Consultation application from Elmbridge Borough Council for the concrete slab overlay and use of the railway straight racetrack for the new driver training in connection with Mercedes-Benz World
DECISION: NO OBJECTION

DELEGATED DECISIONS IN CONSULTATION WITH CHAIRMAN & VICE CHAIRMAN

<u>APP. NO.</u>	<u>LOCATION AND PROPOSAL FOLLOWED BY DECISION</u>
11/0977	Dolphin House, Coopers Hill Lane, Englefield Green Raising of the roof and insertion of dormer to create first floor to existing gate house to provide habitable accommodation. DECISION: GRANT
11/1063	Axim House, 3 Riverside, Egham Erection of single storey side extension DECISION: GRANT
11/1093	Robinswood, Portnall Rise, Virginia Water Erection of 2-storey dwelling with balcony to rear, Juliette balconies on side northern elevation, and basement, erection of detached double garage and entrance gates, following demolition of existing dwelling and garage (revised description 13.12.2011 following amended plans). DECISION: GRANT
11/1115	10 Virginia Avenue, Virginia Water Erection of a detached two storey dwelling with roof space accommodation and attached double garage following the demolition of the existing two storey dwelling and garage. DECISION: GRANT
11/1135	5 Oak Tree Close, Virginia Water Erection of single storey side/front extension DECISION: GRANT
11/1143	8 Clarence Drive, Englefield Green, Egham Renewal of planning permission RU.08/0577 granted for the erection of single storey and first floor rear extension: extension to existing garage with living accommodation above incorporating a front dormer: two storey and single storey front extension: increase in ridge height incorporating two front dormers to allow habitable accommodation at second floor level following demolition of existing single storey front and rear elements. DECISION: GRANT
11/1155	Wickham, 21 Abbots Drive, Virginia Water Erection of 2 storey detached dwelling with accommodation in the loft and attached double garage with accommodation over following the demolition of the existing 2 storey detached dwelling and garage. DECISION: GRANT
11/1163	14 Wavendene Avenue, Egham Erection of a detached garage. DECISION: GRANT
11/1164	Land adj Wey Navigation, Byfleet Road, New Haw Fell 1 Willow Tree marked T1 on submitted plan, remove 6 sycamore marked GRP1 on submitted plan and remove 6 Alder marked GRP2 on submitted plan protected by Conservation Area Status. DECISION: GRANT
11/1166	Lariden, Fairway, Virginia Water Erection of 2 storey detached dwelling with basement accommodation beneath and detached garage following demolition of existing dwelling and outbuildings.

Ancillary works to include erection of replacement vehicular access gates and brick piers.

DECISION: GRANT

11/1177

5 Manor Way, Egham

Retrospective application to remove Condition 4 of planning permission RU.85/0244 (erection of front porch, garage extension and creation of a covered way between existing garage and house) for use as a gym with a shower room ancillary to residential dwelling.

DECISION: GRANT

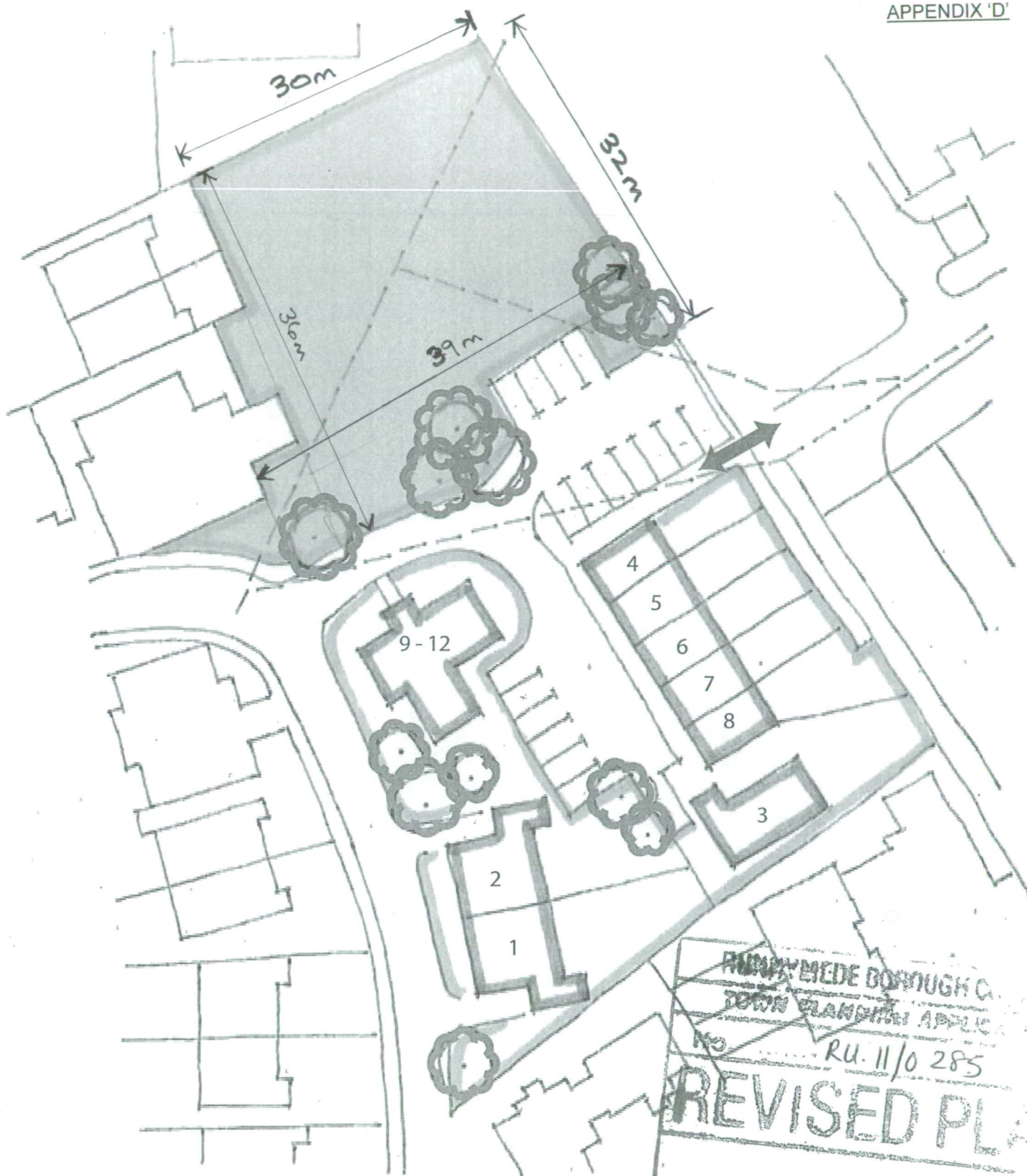

**Land at Palmer Crescent, Ottershaw
Indicative layout**

- Units 1 & 2 : 3 bedroom semi detached houses
- Unit 3 : 2 bedroom bungalow
- Units 4-8 : 2 bedroom terraced houses
- Unit 9-12 : 2 bedroom flats

----- Main service routes

Open space containing children's play and kickabout area

Potential pedestrian link

RUMPKMEDE BOROUGH COUNCIL
TOWN PLANNING APPLICATION
No. RU.11/0 285
REVISED PLAN
(Date rec'd) 18.10.11
COUNCIL

17 8 OCT 2011

TECHNICAL SERVICES

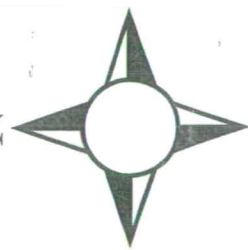

Scale 1:500